

SQUARE FOOTAGE	
FIRST	1612
SECOND	640
TOTAL	2252
BONUS	366
STOOP / PORCH	25
GARAGE	494

ELECTRICAL	COUNT	SYMBOL
ceiling fan globe	6	
pendant light	2	
pot light	15	
wall sconce	1	
fan	2	
fan light combo	1	
light	16	
outlet	45	
switch	42	

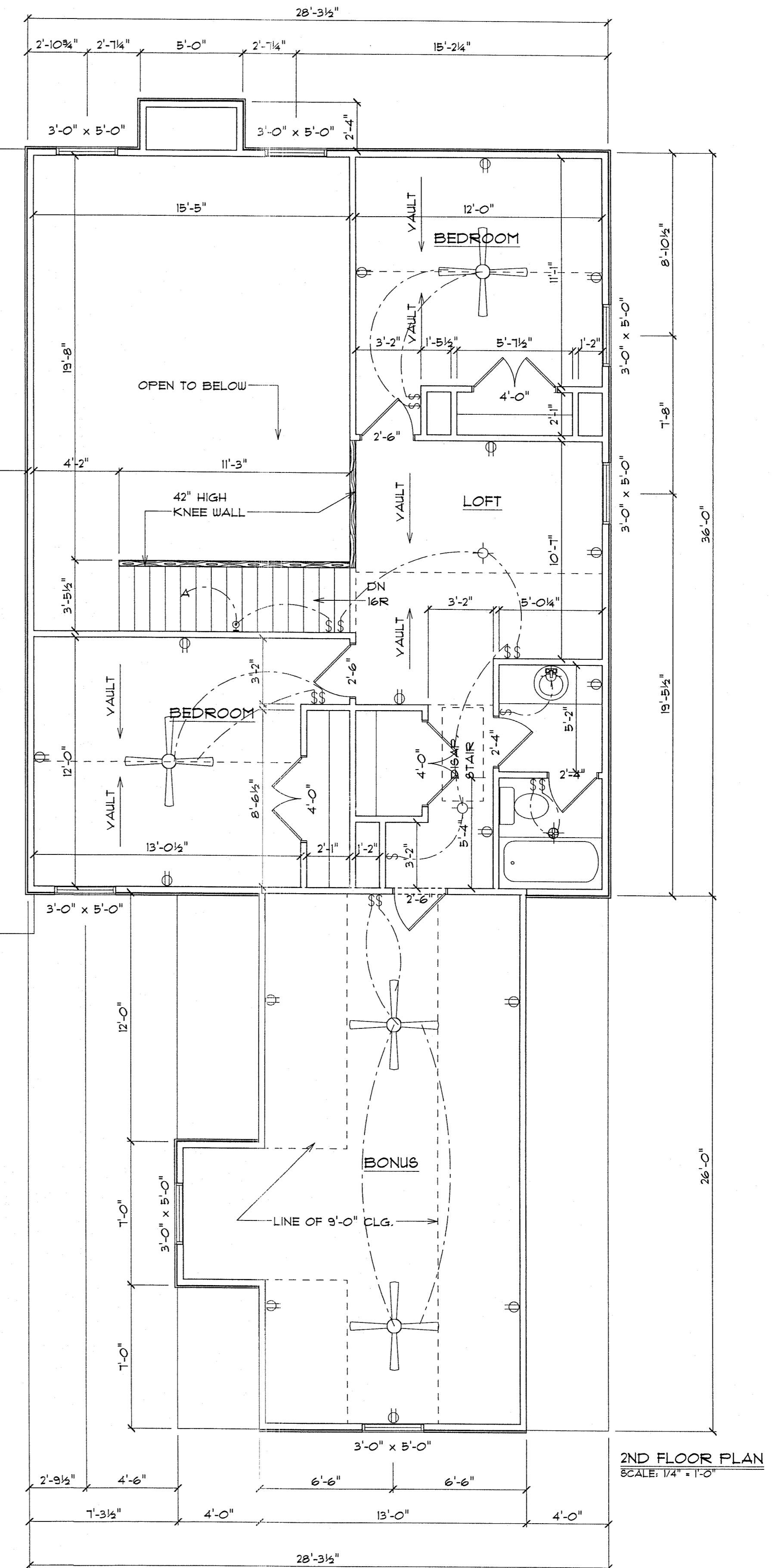

COPYRIGHT NOTE
ALL RIGHTS RESERVED
SOUTHERN CLASSIC DESIGNS
THESE DRAWINGS OR ANY PART THEREOF SHALL BE THE PROPERTY OF SOUTHERN CLASSIC DESIGNS AND SHALL NOT BE REPRODUCED, COPIED, OR TRANSMITTED IN ANY FORM OR BY ANY MEANS, WITHOUT THE WRITTEN CONSENT OF SOUTHERN CLASSIC DESIGNS. THESE DRAWINGS ARE NOT TO BE USED FOR ANY OTHER PROJECT WITHOUT THE WRITTEN CONSENT OF SOUTHERN CLASSIC DESIGNS. THE USER ASSUMES ALL LIABILITY FOR ANY DAMAGE OR INJURY THAT MAY BE CAUSED BY ANY FABRICATION, INSTALLATION, OR USE OF THESE DRAWINGS. SOUTHERN CLASSIC DESIGNS AND SOUTHERN CLASSIC DESIGNS ARCHITECTS ARE NOT RESPONSIBLE FOR ANY DAMAGE OR INJURY THAT MAY BE CAUSED BY ANY FABRICATION, INSTALLATION, OR USE OF THESE DRAWINGS.

THE FRANKLIN

DENNIS ARMSTRONG
P.O. DRAWER 480
BARNESVILLE GA. 30204
PHONE T70-356-1438
FAX T70-356-2161

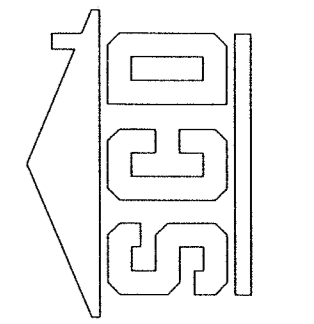

JOB NUMBER:
1800

CAMBRON SUBDIVISION
LOT 49
SPANISH FORT, AL